

Transports en commun - Amélioration de la desserte des communes de Saint-Médard-en-Jalles, Le Haillan, Eysines et Le Taillan-Médoc par l'extension du réseau de tramway

## DOSSIER DE PLANS

# 3/ PROFILS EN TRAVERS PROPOSÉS POUR LE TRACÉ 1



# PROFILS EN TRAVERS TYPE

## Section courante

PROFIL EN TRAVERS TYPE 1 (PT1)  
SANS PISTE CYCLABLE

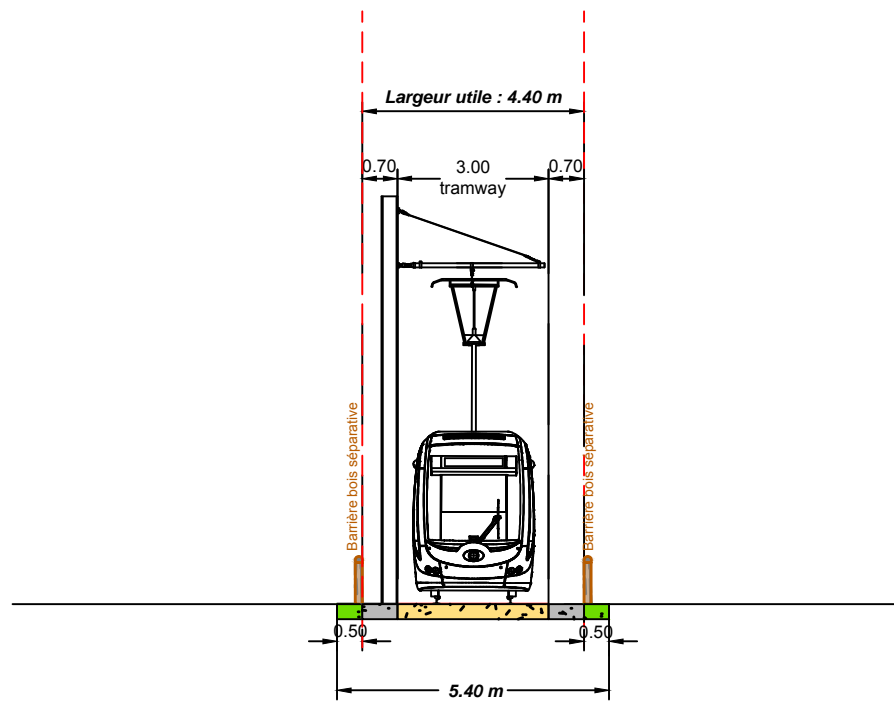

PROFIL EN TRAVERS TYPE2 (PT2)  
AVEC PISTE CYCLABLE

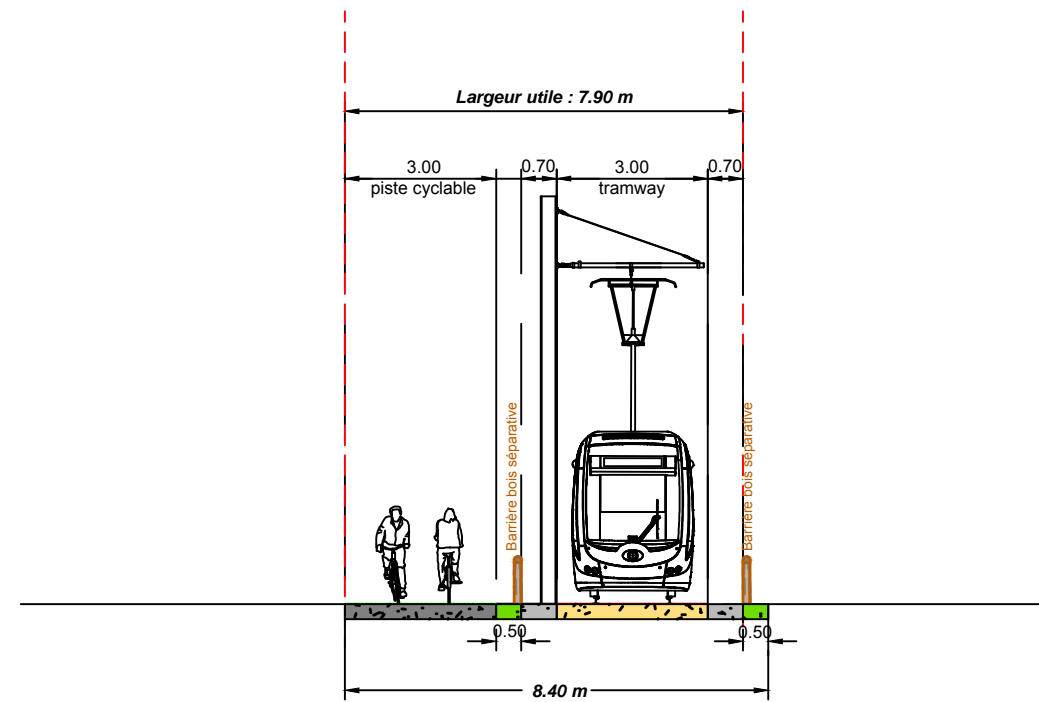

ETAT PROJETE  
AVEC HYPOTHESE DE 30CM DE RACCORD AU TN  
(SANS PISTE CYCLABLE)

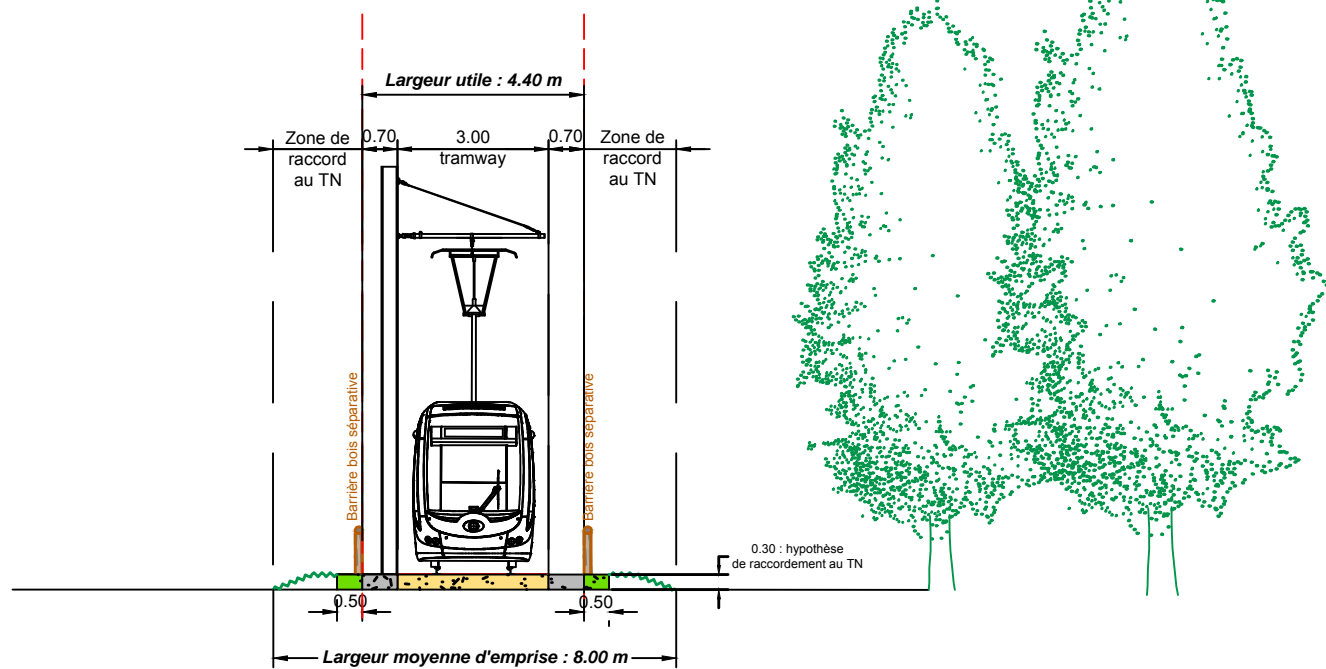

ETAT PROJETE  
AVEC HYPOTHESE DE 30CM DE RACCORD AU TN  
(AVEC PISTE CYCLABLE)

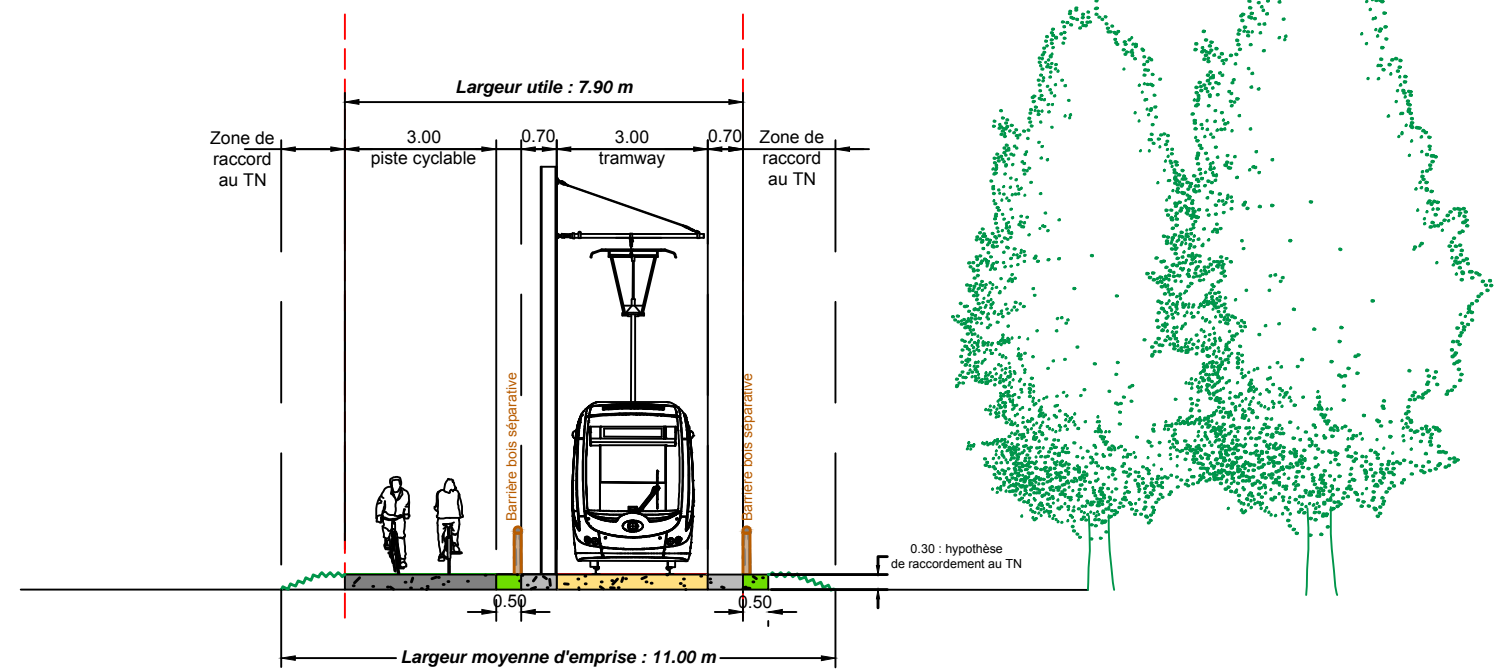

**SEQUENCES 1 & 2**  
 (planche 01)  
 Emprise existante : 5.10 m

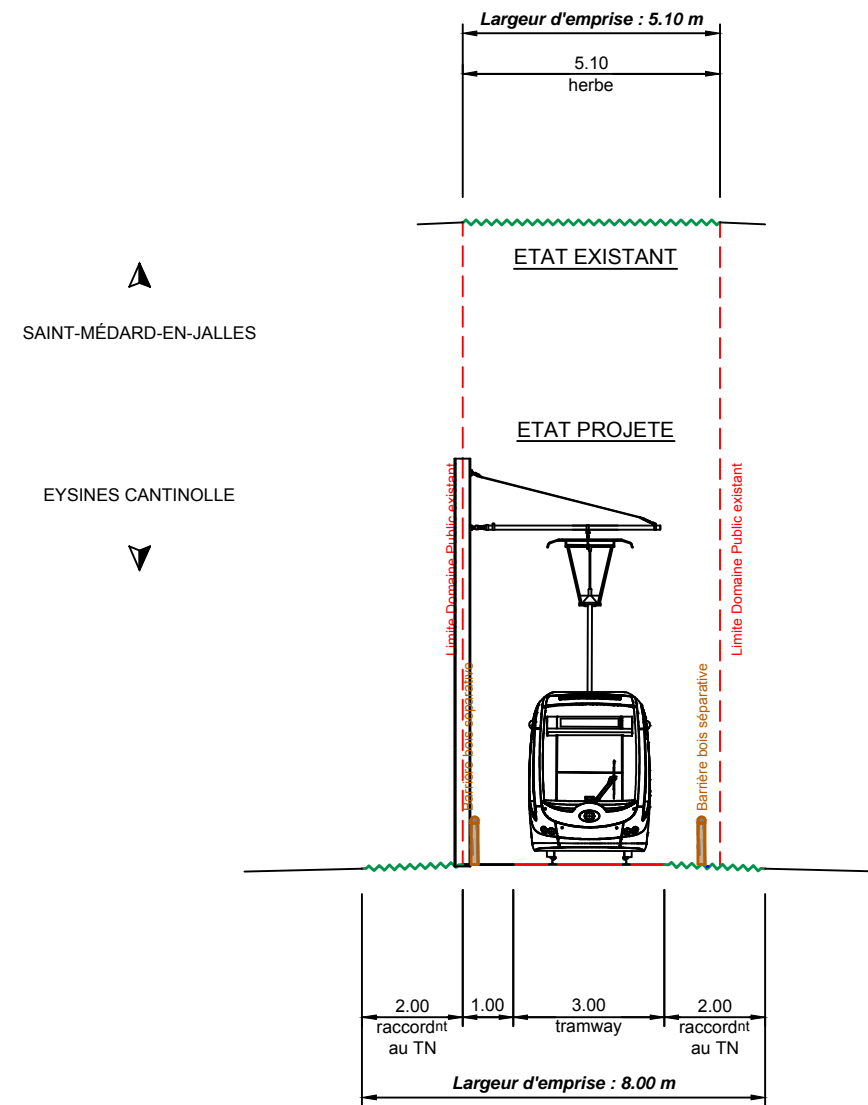

**SEQUENCE 3**  
(planche 02)  
Emprise existante : 11.30 m

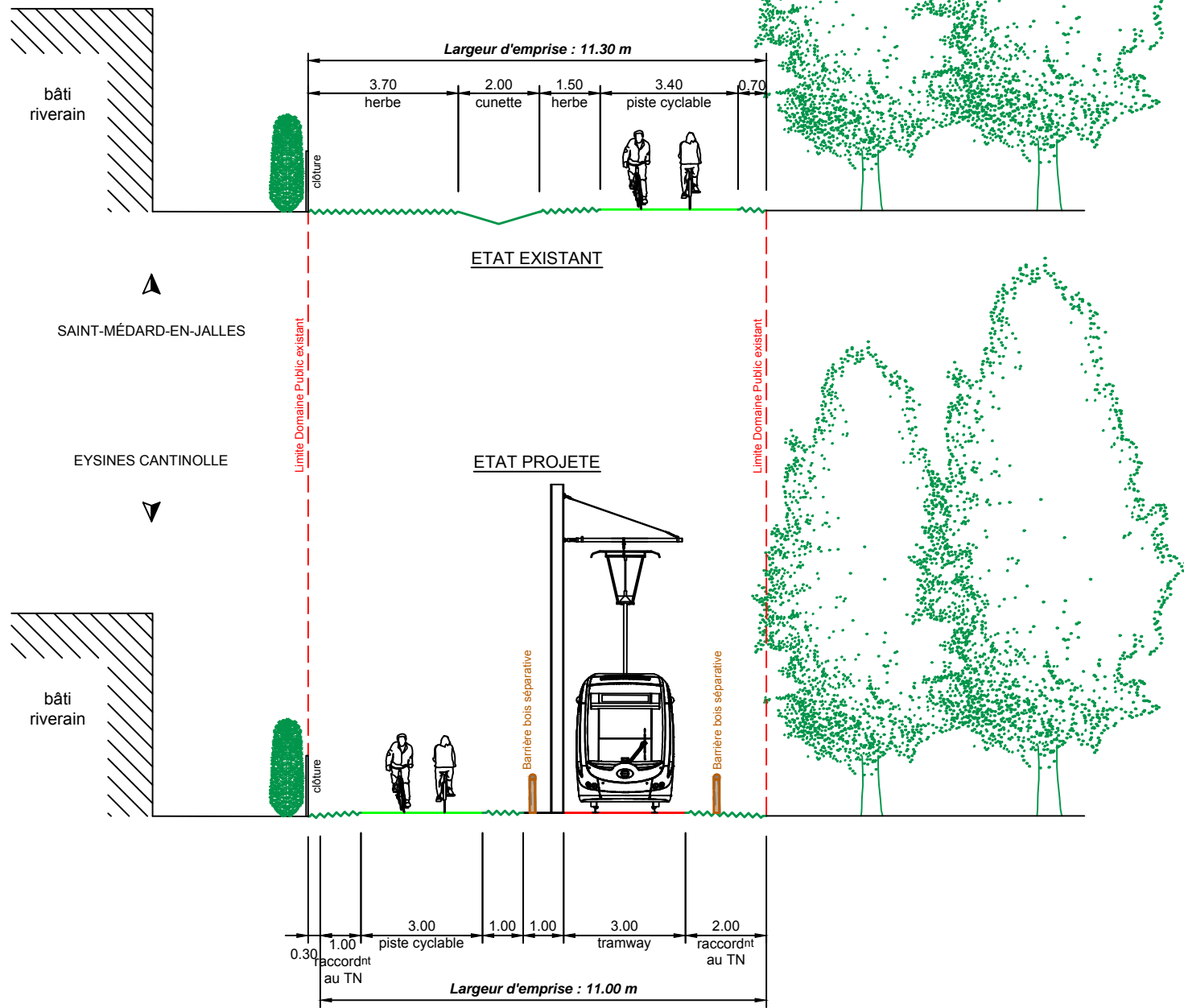

**SEQUENCE 3**  
(planche 02)  
Emprise existante : 12.50 m

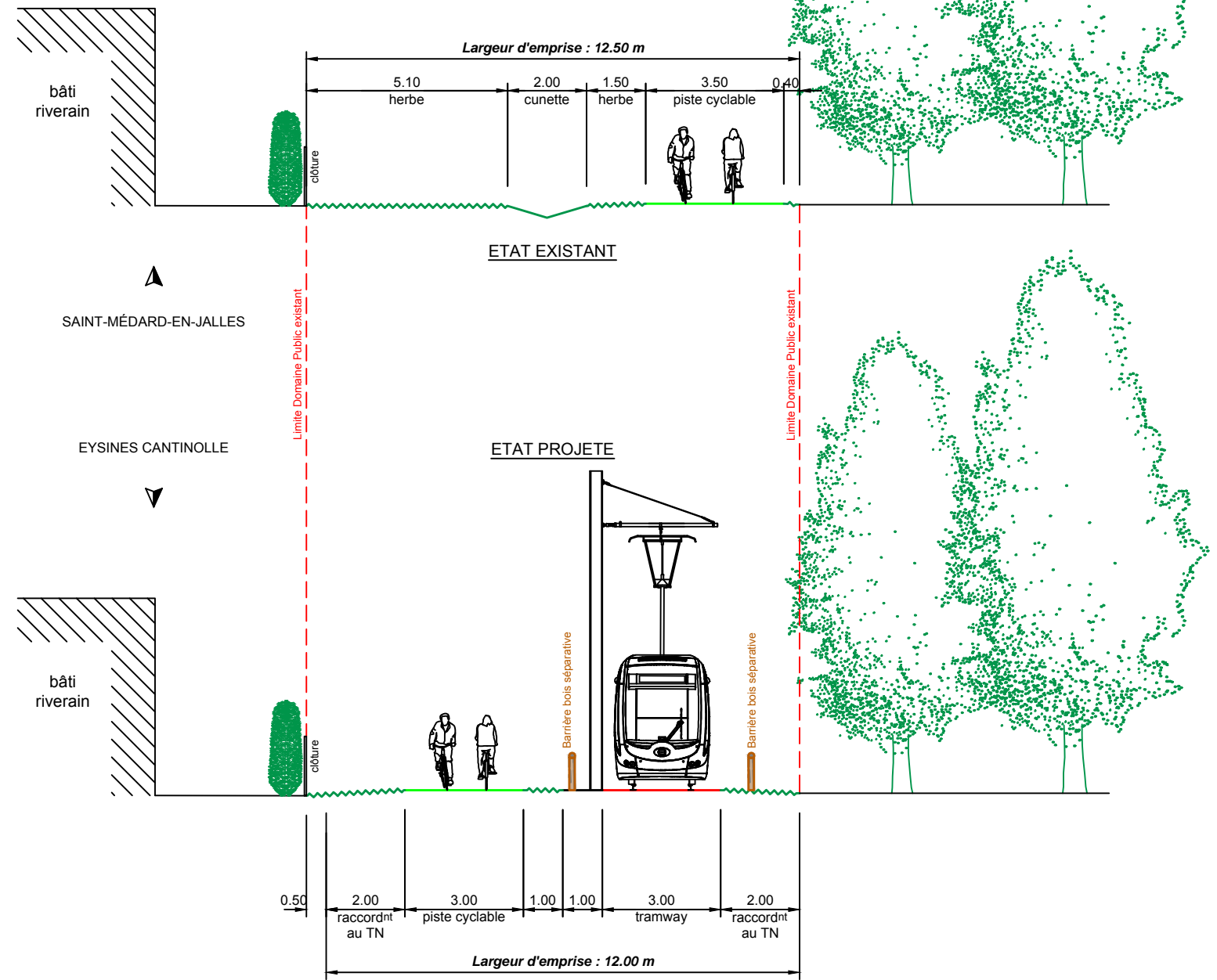

**SEQUENCE 5**  
 (planche 04)  
 Emprise existante : 19.00 m

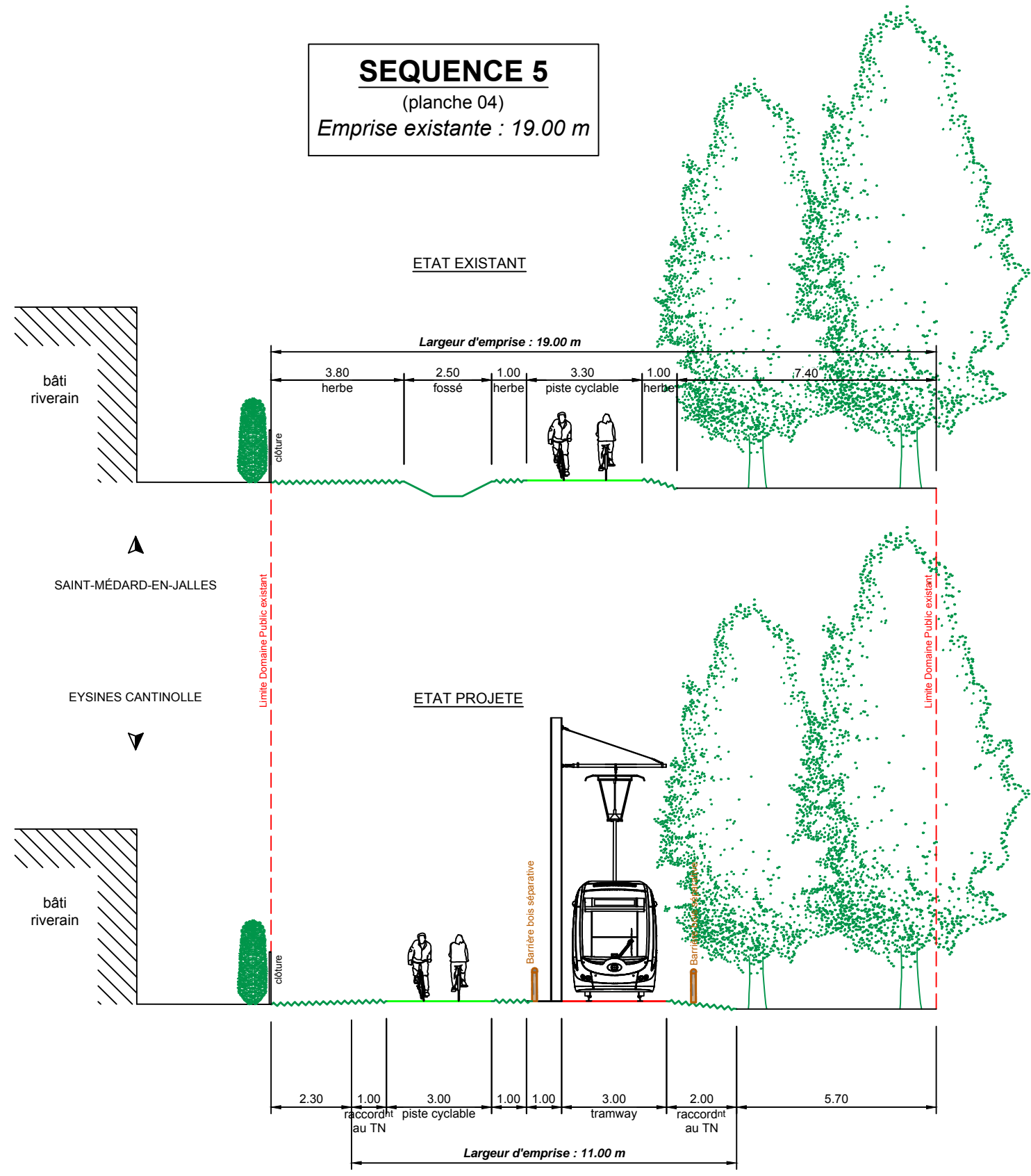



**SEQUENCE 5**  
 (planche 04)  
 Emprise existante : 14.00 m

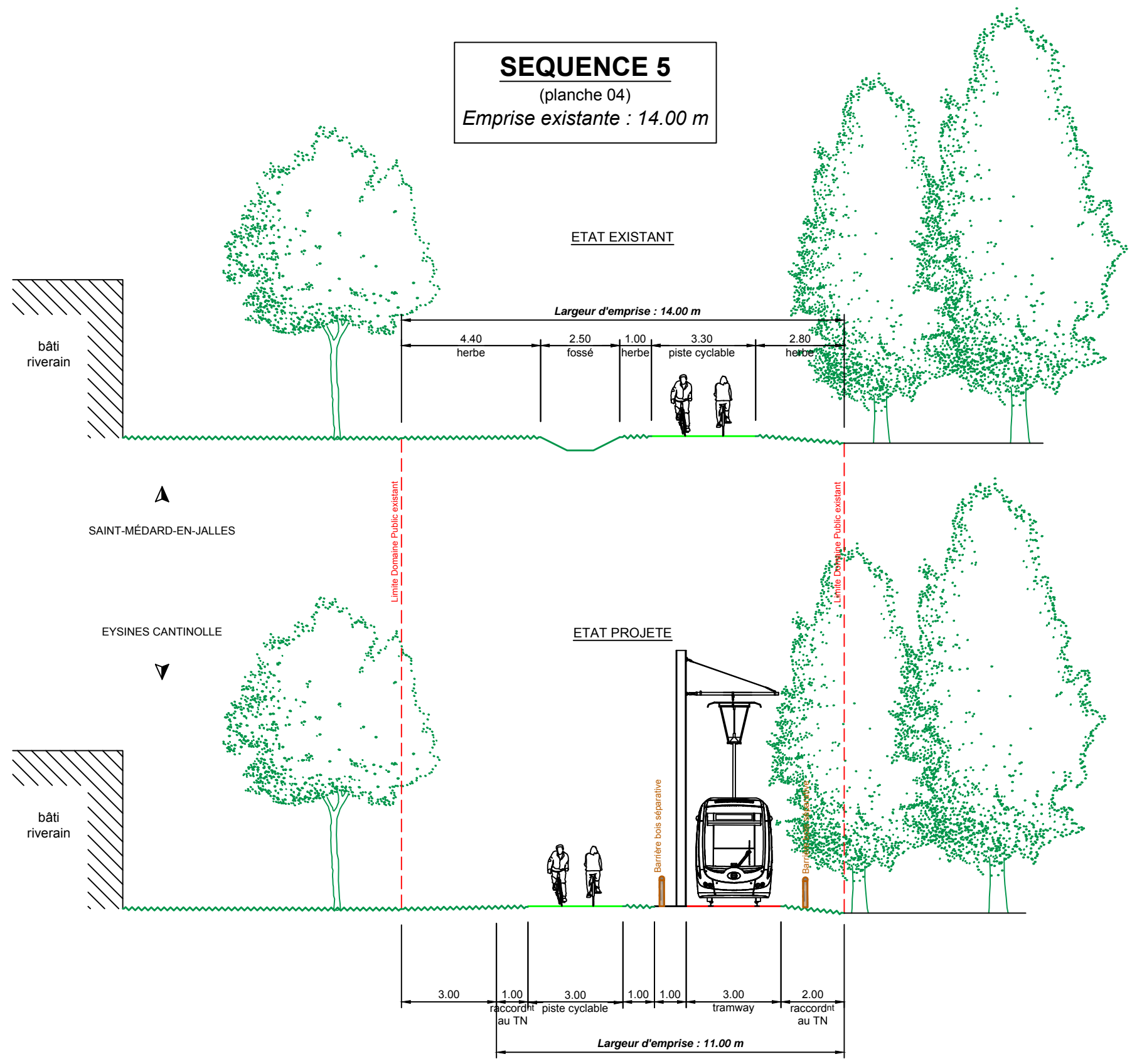

**SEQUENCE 6**  
 (planche 05)  
 Emprise existante : 15.00 m

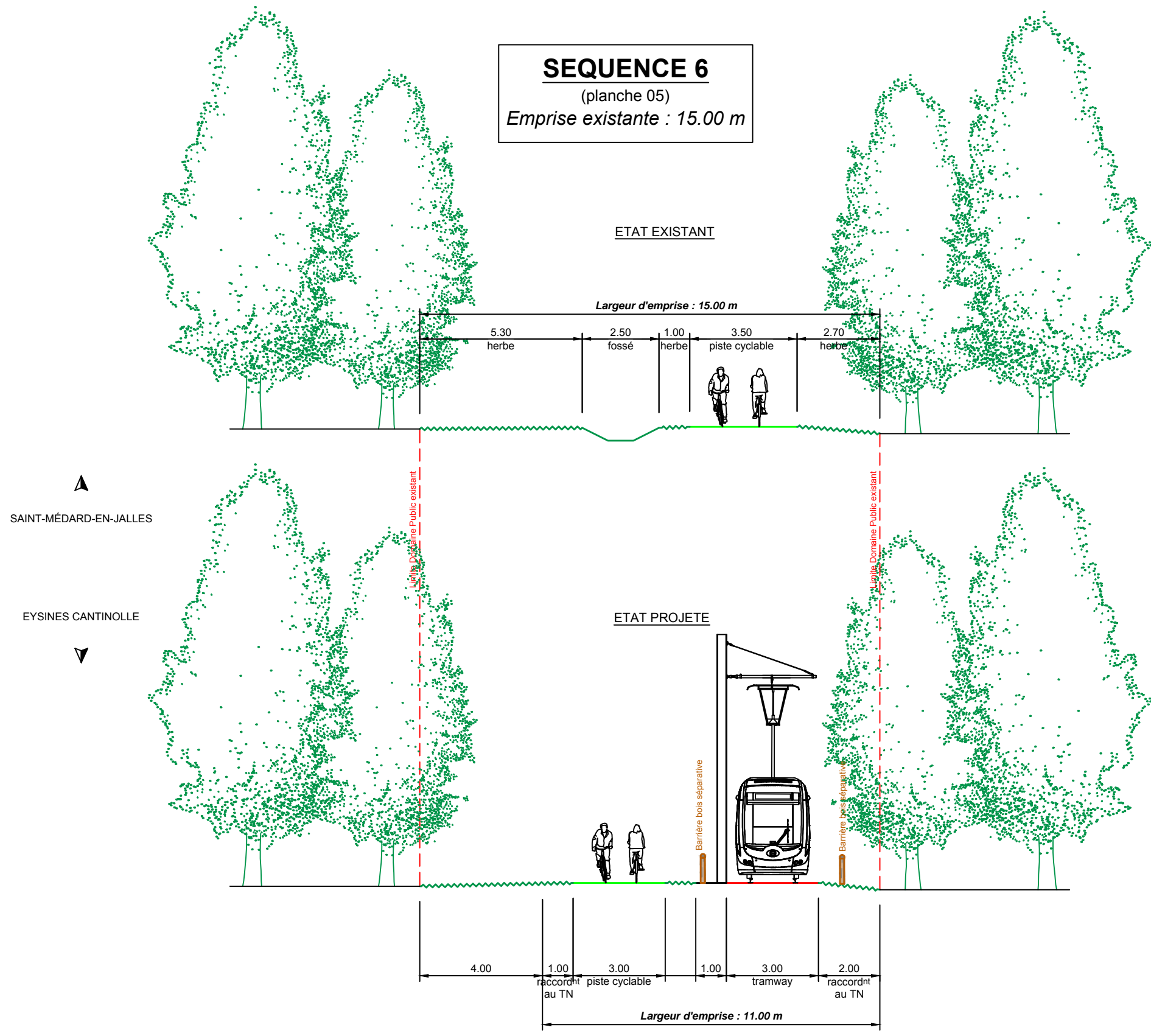

**SEQUENCE 7**  
 (planche 06)  
 Emprise existante : 12.50 m

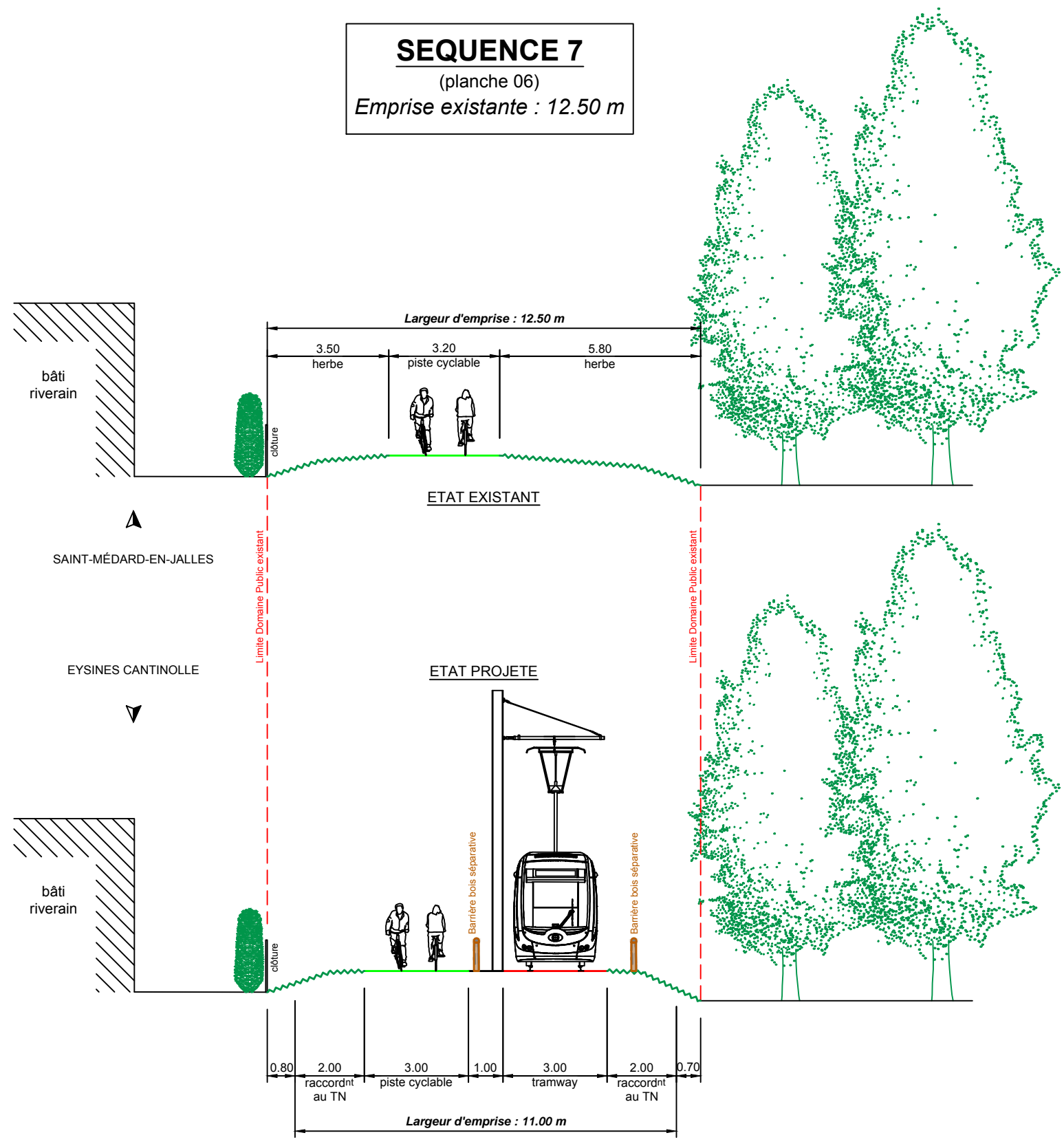



**SEQUENCE 7**  
 (planche 06)  
 Emprise existante : 11.00 m

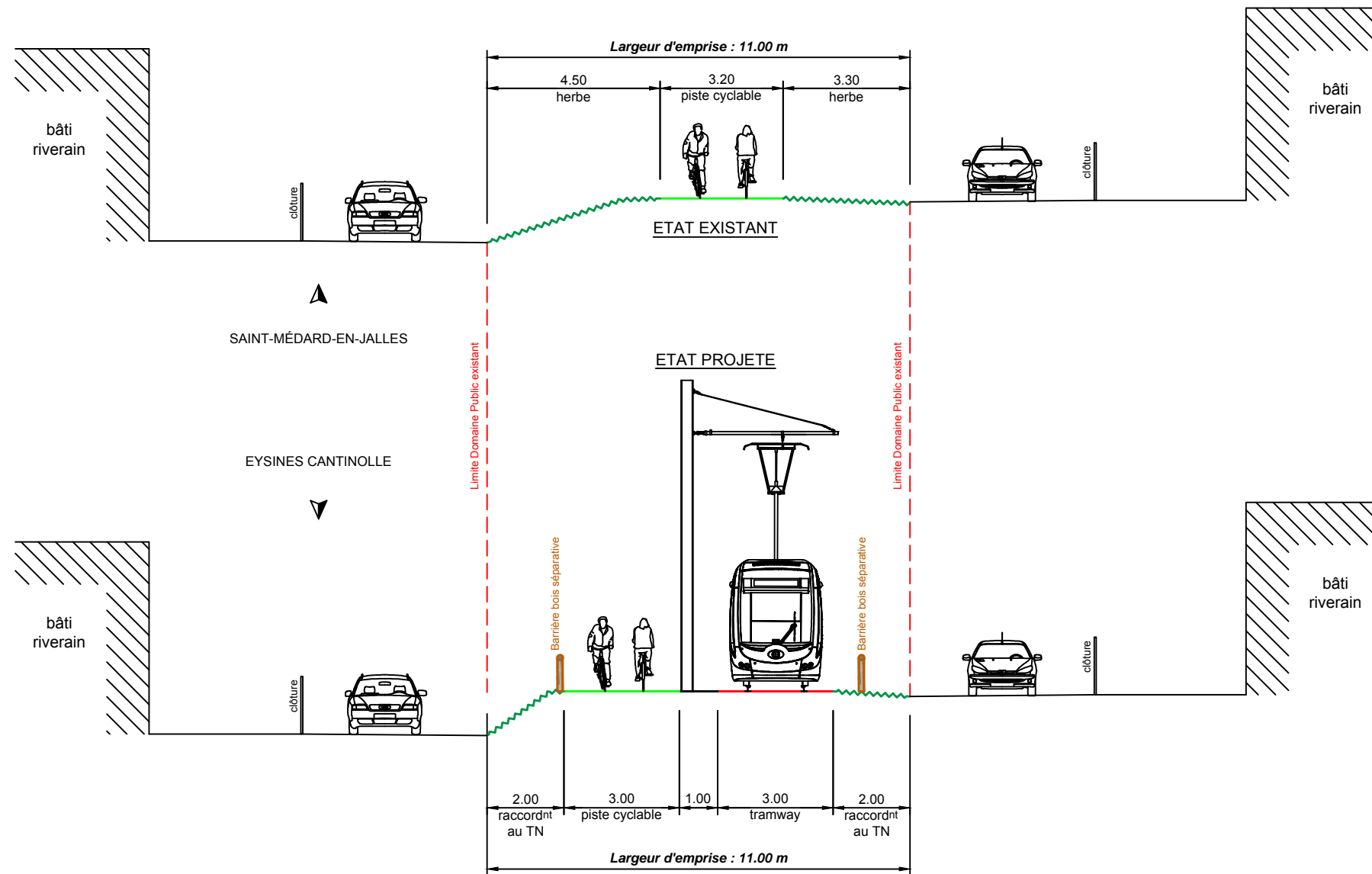

**SEQUENCE 7**  
(planche 07)  
Emprise existante : 10.00 m

**SEQUENCE 7**  
(planche 07)  
Emprise existante : 10.00 m

