

DIRECTION DE L'INFORMATION GEOGRAPHIQUE -

SERVICE TOPOGRAPHIE

COMMUNE
de BORDEAUX

**ENQUETE PUBLIQUE PREALABLE
A LA MODIFICATION DE PLAN D'ALIGNEMENT**

RUE DE RIVIERE

PLAN D'ALIGNEMENT

ETAT FUTUR

NUMERO DE CLASSEMENT
9495

DRESSÉ LE : 02/04/2021
PAR : D.I.G.

Service Topographie
Centre de Définition des Alignements
herve@bordeaux-metropole.fr

Tel : 05 56 99 84 84 - Poste 28472
Bordeaux Métropole
Espace Charles de Gaulle/BORDEAUX

MODIFICATIONS

D.I.G

PROJETEUR :

Damien BRACHET

ADMISSION LE : 02/04/2021
LE CHEF DU SERVICE TOPOGRAPHIE
SYLVAIN COSTEMALE

SERVICE DEMANDEUR :

HERVÉ : HANOÏ-GRANGER Caroline
c.hanoig@bordeaux-metropole.fr 0533939629
Dr. Devl. Aménagement PTBORDAUX



PLAN DE MASSE

Etat futur

PLANCHE 1

LEGENDE

— Alignement à approuver

- - - Limite parcelle cadastrale

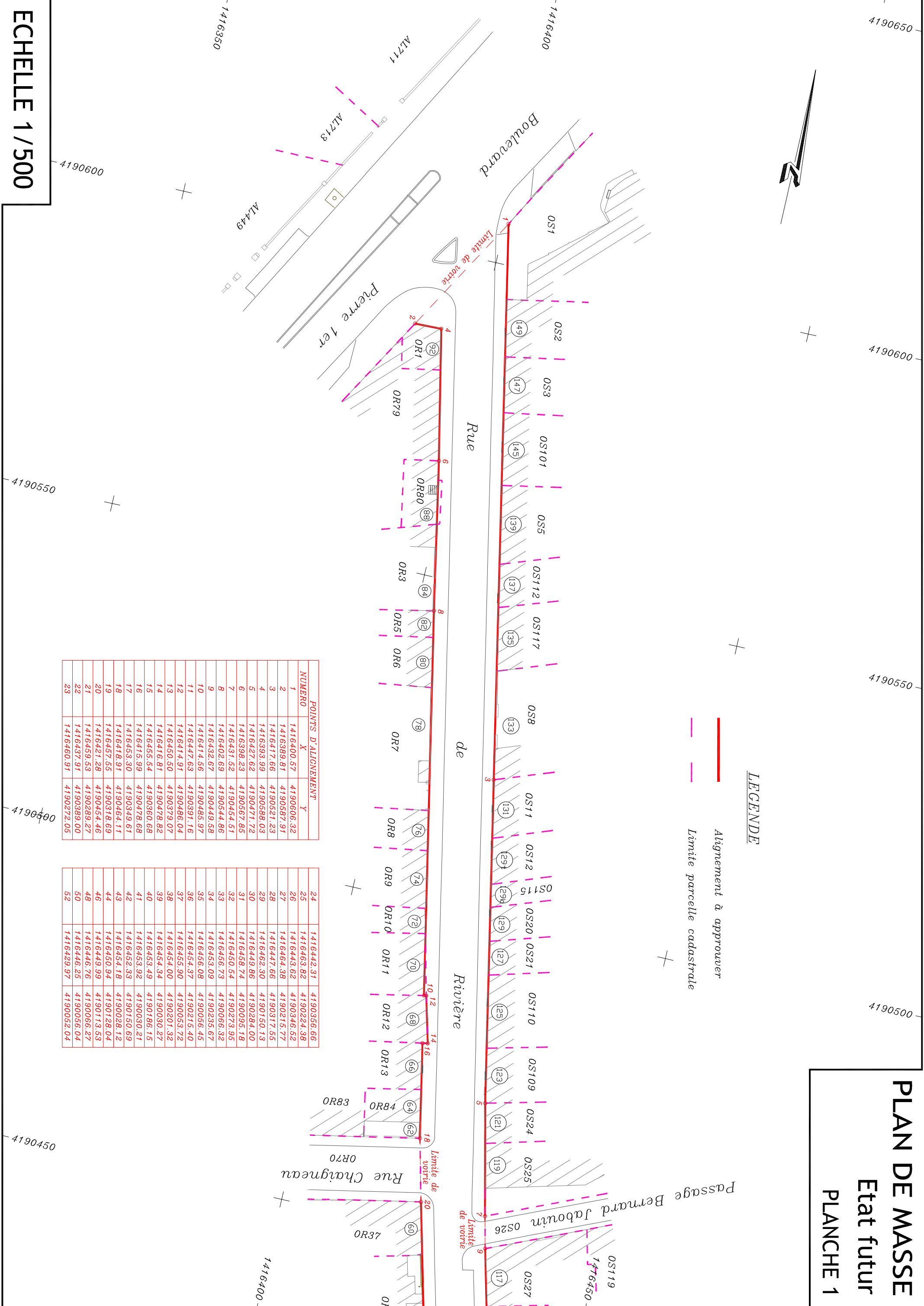

NUMERO	POINTS D'ALIGNEMENT	
	X	Y
1	1416400.57	4190606.32
2	1416389.81	4190587.91
3	1416417.66	4190521.23
4	1416393.99	4190588.03
5	1416427.62	4190471.72
6	1416398.23	4190567.85
7	1416431.52	4190454.51
8	1416402.69	4190544.86
9	1416432.67	4190449.58
10	1416414.56	4190485.97
11	1416447.63	4190391.16
12	1416414.91	4190486.04
13	1416450.50	4190379.07
14	1416416.81	4190478.82
15	1416455.54	4190360.68
16	1416415.99	4190478.68
17	1416453.30	4190349.61
18	1416418.91	4190464.11
19	1416457.55	4190318.69
20	1416421.28	4190454.46
21	1416459.53	4190289.27
22	1416437.91	4190389.00
23	1416460.91	4190272.05

24	1416442.31	4190356.66
25	1416463.82	4190224.38
26	1416443.62	4190346.52
27	1416464.38	4190215.77
28	1416447.66	4190317.55
29	1416462.30	4190150.13
30	1416449.86	4190284.00
31	1416458.74	4190095.18
32	1416450.54	4190273.95
33	1416456.73	4190066.32
34	1416453.08	4190235.67
35	1416456.08	4190056.45
36	1416454.37	4190215.40
37	1416455.90	4190053.72
38	1416454.00	4190201.32
39	1416454.34	4190030.27
40	1416453.49	4190186.15
41	1416453.92	4190030.21
42	1416452.33	4190150.69
43	1416454.18	4190028.12
44	1416450.94	4190128.04
46	1416449.99	4190113.53
48	1416446.76	4190066.27
50	1416446.25	4190056.04
52	1416429.97	4190052.04

ECHELLE 1/500

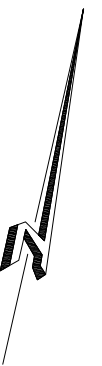

4190450

4190400

4190350

4190300

LEGENDE

- Alignement à approuver
- - - Limite parcelle cadastrale

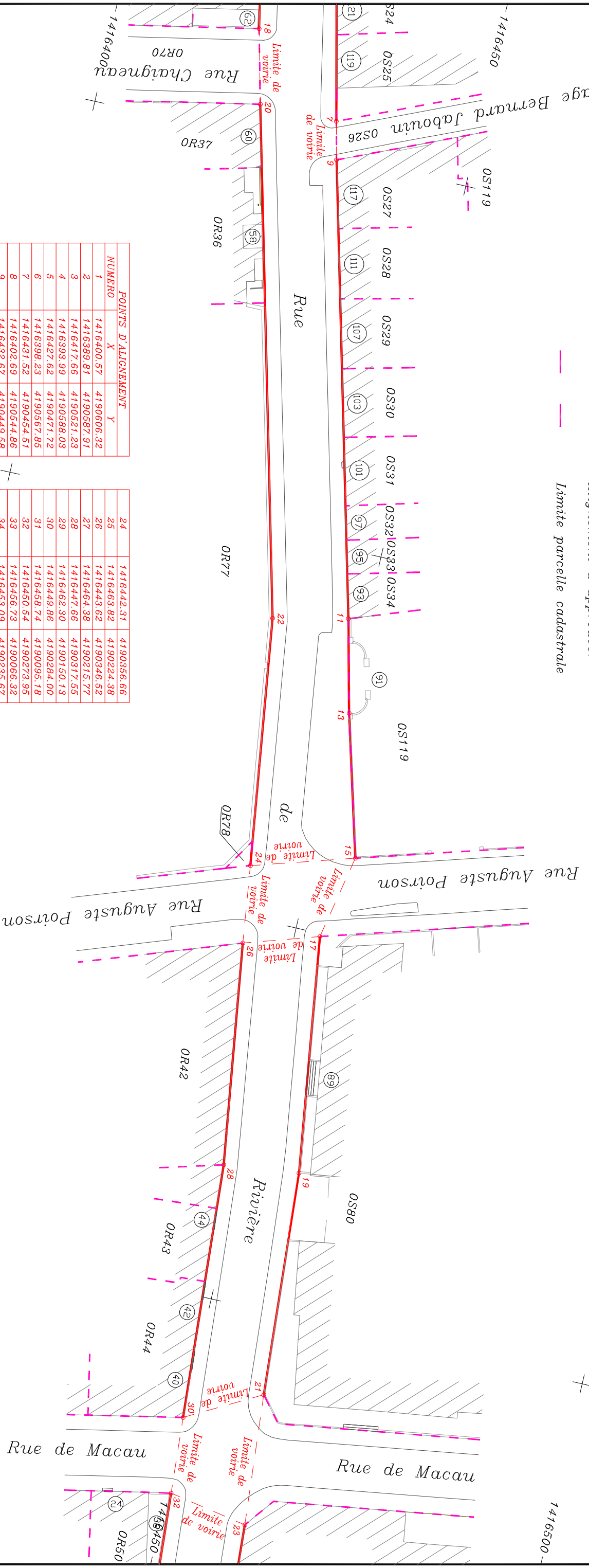

NUMERO	POINTS D'ALIGNEMENT	
	X	Y
1	1416400.57	4190606.32
2	1416389.81	4190587.91
3	1416417.66	4190521.23
4	1416393.99	4190588.03
5	1416427.62	4190471.72
6	1416398.23	4190567.85
7	1416431.52	4190454.51
8	1416402.69	4190544.86
9	1416432.67	4190449.58
10	1416414.56	4190485.97
11	1416447.63	4190391.16
12	1416414.91	4190486.04
13	1416450.50	4190379.07
14	1416416.81	4190478.82
15	1416455.54	4190360.68
16	1416415.99	4190478.68
17	1416453.30	4190349.61
18	1416418.91	4190464.11
19	1416457.55	4190318.69
20	1416421.28	4190454.46
21	1416459.53	4190289.27
22	1416437.91	4190389.00
23	1416460.91	4190272.05

24	1416442.31	4190356.66
25	1416463.82	4190224.38
26	1416443.62	4190346.52
27	1416464.38	4190215.77
28	1416447.66	4190317.55
29	1416462.30	4190150.13
30	1416449.86	4190284.00
31	1416458.74	4190095.18
32	1416450.54	4190273.95
33	1416456.73	4190066.32
34	1416453.09	4190235.67
35	1416456.08	4190056.45
36	1416454.37	4190215.40
37	1416455.90	4190053.72
38	1416454.00	4190201.32
39	1416454.34	4190050.27
40	1416453.49	4190186.15
41	1416453.92	4190030.21
42	1416452.33	4190150.69
43	1416454.18	4190028.12
44	1416450.94	4190128.04
46	1416449.99	4190113.53
48	1416446.76	4190066.27
50	1416446.25	4190056.04
52	1416429.97	4190052.04

ECHELLE 1/500

4190400

4190350

4190300

1416400

PLAN DE MASSE
Etat futur
PLANCHE 2

PLAN DE MASSE

Etat futur

PLANCHE 3

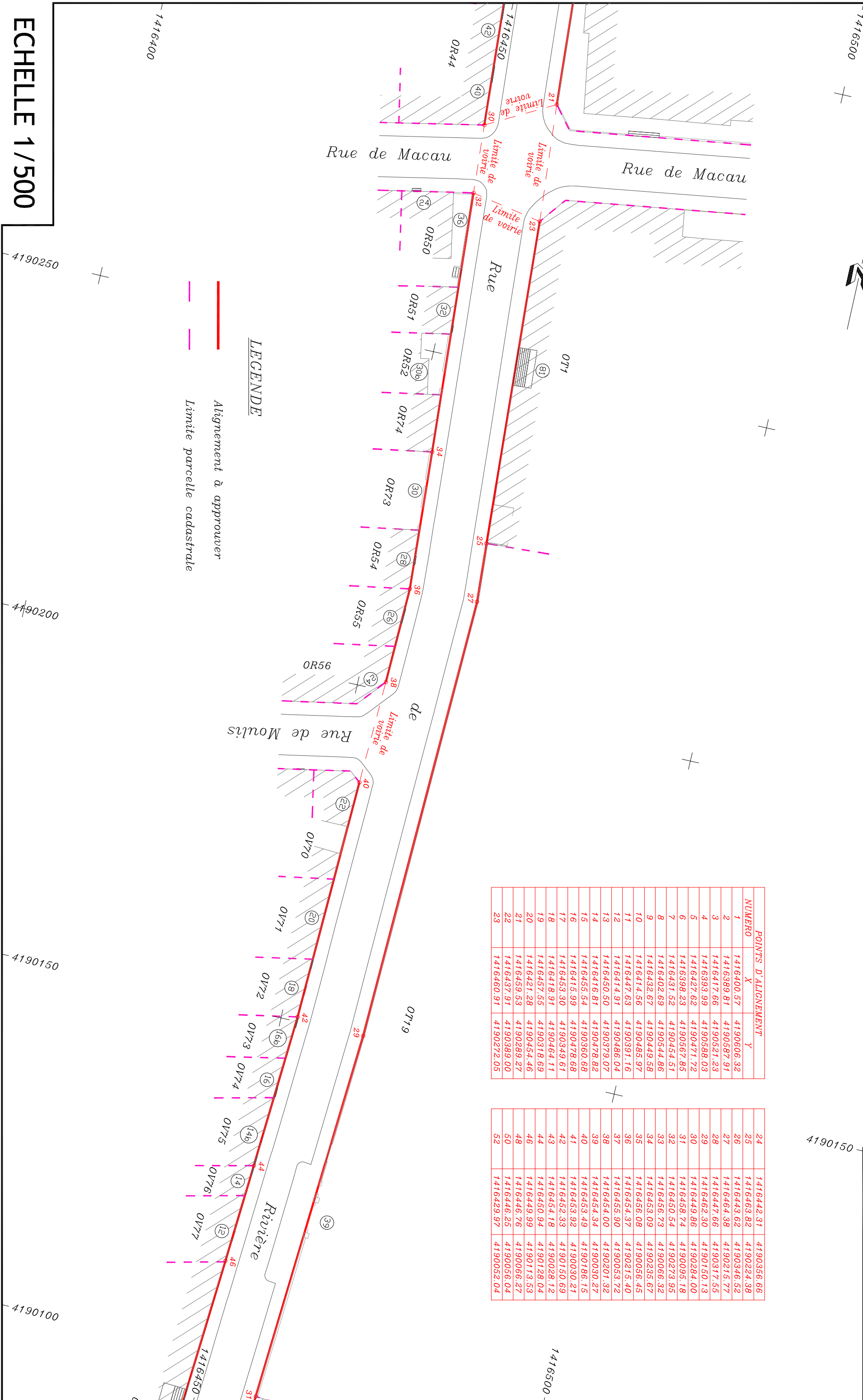
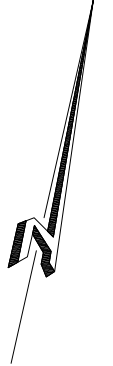

LEGENDE

- Alignement à approuver
- - - Limite parcelle cadastrale

NUMERO	X	Y
1	1416400.57	4190606.32
2	1416389.81	4190587.91
3	1416417.66	4190521.23
4	1416393.99	4190588.03
5	1416427.62	4190471.72
6	1416398.23	4190567.85
7	1416431.52	4190454.51
8	1416402.69	4190544.86
9	1416432.67	4190449.58
10	1416414.56	4190485.97
11	1416447.63	4190391.16
12	1416414.91	4190486.04
13	1416450.50	4190379.07
14	1416416.81	4190478.82
15	1416455.54	4190380.68
16	1416415.99	4190380.68
17	1416453.30	4190349.61
18	1416418.91	4190464.11
19	1416457.55	4190318.69
20	1416421.28	4190454.46
21	1416459.53	4190289.27
22	1416437.91	4190389.00
23	1416460.91	4190272.05

24	1416442.31	4190356.66
25	1416463.82	4190224.38
26	1416443.62	4190346.52
27	1416464.38	4190215.77
28	1416447.66	4190317.55
29	1416462.30	4190150.13
30	1416449.86	4190284.00
31	1416458.74	4190095.18
32	1416450.54	4190273.95
33	1416456.73	4190066.32
34	1416453.09	4190235.67
35	1416456.08	4190056.45
36	1416454.37	4190215.40
37	1416455.90	4190053.72
38	1416454.00	4190201.32
39	1416454.34	4190030.27
40	1416453.49	4190186.15
41	1416453.92	4190030.21
42	1416452.33	4190150.69
43	1416454.18	4190028.12
44	1416450.94	4190128.04
46	1416449.99	4190113.53
48	1416446.76	4190066.27
50	1416446.25	4190056.04
52	1416429.97	4190052.04

ECHELLE 1/500

4190250

4190200

4190150

4190100

1416500

4190300

4190250

4190200

1416550

4190150

1416500

1416400

1416450

PLAN DE MASSE

Etat futur

PLANCHE 4

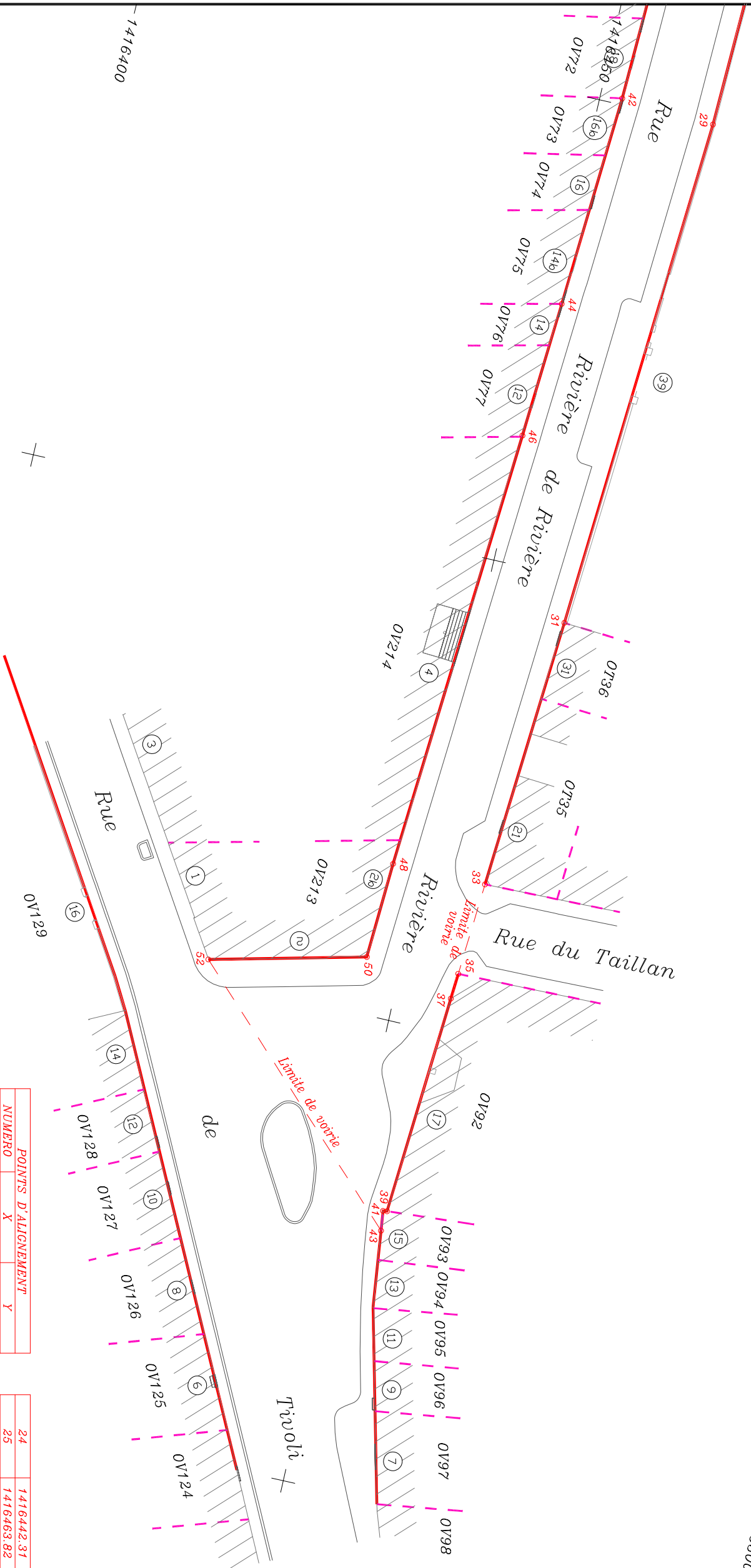
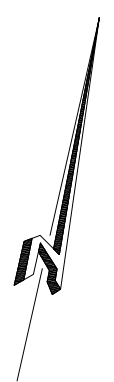

LEGENDE

- Alignement à approuver
- - - Limite parcelle cadastrale

NUMERO	POINTS D'ALIGNEMENT	
	X	Y
1	1416400.57	4190606.32
2	1416389.81	4190587.91
3	1416417.66	4190521.23
4	1416393.99	4190588.03
5	1416427.62	4190471.72
6	1416398.23	4190567.85
7	1416431.52	4190454.51
8	1416402.69	4190544.86
9	1416432.67	4190449.58
10	1416414.56	4190485.97
11	1416447.63	4190391.16
12	1416414.91	4190486.04
13	1416450.50	4190379.07
14	1416416.81	4190478.82
15	1416455.54	4190360.68
16	1416415.99	4190478.68
17	1416453.30	4190349.61
18	1416418.91	4190464.11
19	1416457.55	4190318.69
20	1416421.28	4190454.46
21	1416459.53	4190289.27
22	1416437.91	4190389.00
23	1416460.91	4190272.05
24	1416442.31	4190356.66
25	1416463.82	4190224.38
26	1416443.62	4190346.52
27	1416464.38	4190215.77
28	1416447.66	4190317.55
29	1416462.30	4190150.13
30	1416449.86	4190284.00
31	1416458.74	4190095.18
32	1416450.54	4190273.95
33	1416456.73	4190066.32
34	1416453.09	4190235.95
35	1416456.08	4190056.45
36	1416454.37	4190215.40
37	1416455.90	4190053.72
38	1416454.00	4190201.32
39	1416454.34	4190030.27
40	1416453.49	4190186.15
41	1416453.92	4190030.21
42	1416452.33	4190150.69
43	1416454.18	4190028.12
44	1416450.94	4190128.04
46	1416449.99	4190113.53
48	1416446.76	4190066.27
50	1416446.25	4190056.04
52	1416429.97	4190052.04

ECHELLE 1/500

4190100

4190050

4190000

4189950

1416400

1416450

1416500

4190150

4190100

4190050

1416500